

C VIEW

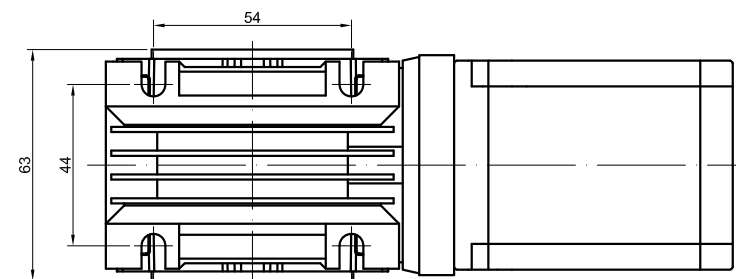

SPECIFICATION	CONNECTION	BIPOLAR
AMPS/PHASE		2.80
RESISTANCE/PHASE(Ohms)@25°C		1.13±10%
INDUCTANCE/PHASE(mH)@1KHz		4.80±20%
HOLDING TORQUE w/o GEARBOX(Nm)[lb-in]		1.90[16.82]
STEP ANGLE w/o GEARBOX(°)		1.80±5.00%
GEAR RATIO		5
MAX.PERMISSIBLE TORQUE(Nm)[lb-in]		18.00[159.31]
EFFICIENCY		87%
SHAFT MAXIMUM RADIAL LOAD(kN)		0.57
BACKLASH@NO-LOAD(°)		1
TEMPERATURE RISE:MAX.80°C (MOTOR STANDSTILL;FOR 2PHASE ENERGIZED)		
AMBIENT TEMPERATURE -10°C~50°C[14°F~122°F]		
INSULATION RESISTANCE 100 Mohm (UNDER NORMAL TEMPERATURE AND HUMIDITY)		
INSULATION CLASS B 130°C[266°F]		
DIELECTRIC STRENGTH 500VAC FOR 1MIN.(BETWEEN THE MOTOR COILS AND THE MOTOR CASE)		

PIN NO	TYPE OF CONNECTION (EXTERN)		MOTOR	
	BIPOLAR	LEADS	WINDING	
1	A+ —	BLK	A+	
2	A- —	GRN	A-	
3	B+ —	RED	B+	
4	B- —	BLU	B-	

FULL STEP 2 PHASE-Ex. ,  
WHEN FACING MOUNTING END (X)

STEP	A+	B+	A-	B-		CCW
1	+	+	-	-	↓	↑
2	-	+	+	-		
3	-	-	+	+	↑	↓
4	+	-	-	+		

**SKYSMotor**

APVD		11.7.2022
CHKD		
1:1.5	DRN	
SCALE	SIGNATURE	DATE

**STEPPER MOTOR**

**23HS30-2804S-RV30-G5**