

SPECIFICATION	CONNECTION	VALUE
GEAR RATIO		10
EFFICIENCY		96.00%
BACKLASH@NO-LOAD(arcmin)		<=15
MAX.PERMISSIBLE TORQUE(Nm)[lb-in]		5.00[44.25]
MOMENT PERMISSIBLE TORQUE(Nm)[lb-in]		10.00[88.51]
GEARBOX MATCHING MOTOR'S INPUT SHAFT LENGTH (mm)		24
NOISE(dB)		<=55
WATERPROOF RATING		IP54
LIFE(h)		20000
AMBIENT TEMPERATURE		-10°C~90°C[14°F~194°F]

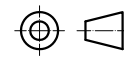

**SKYSMotor**

	APVD		3.2.2021
	CHKD		
1:1	DRN		
SCALE	SIGNATURE		DATE

**PLANETARY GEARBOX**

**TQEG17-G10**